

- 6 Take one measurement once per day unless otherwise advised by your healthcare provider.** The LED on your Tenovi device will turn **Red** at the beginning of each day indicating you must take measurement for that day. The LED ring will turn **Green** when you successfully take a measurement and transmit it to your healthcare provider.



Measurement Needed



Measurement Successful



© 2021 Tenovi Co.

All rights reserved. Reproduction, duplication or modification in whole or in part is prohibited without prior written permission from Tenovi. All trademarks are owned by or licensed to Tenovi, Co. unless otherwise noted.

Revision 05.01.2021



Warning

This device was issued to you from your doctor.
You must wait for a phone call for your assigned care manager before setting up this device.

1

Plug your gateway into a power outlet with the provided power cord and wait until the LED on the gateway turns **red**.

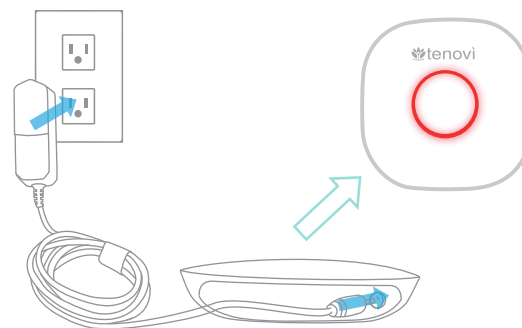

2

Remove the battery cover and insert the batteries into the back side of your Peak Flow Meter

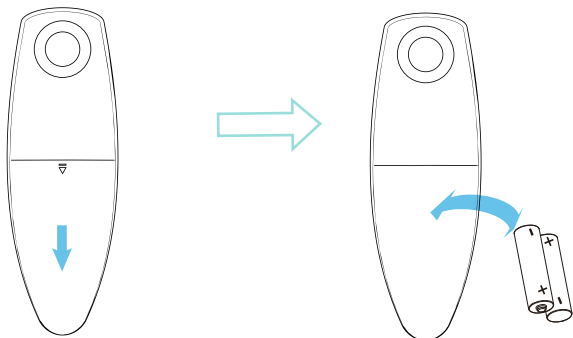

3

Stand within 20 feet of the Tenovi Gateway, press the power button for 3 seconds and wait for the Tenovi Gateway to start flashing yellow.

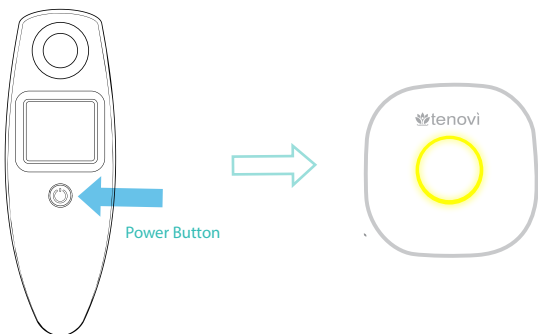

4

Take a deep breath and then exhale quickly into the Tenovi Peak Flow Meter.

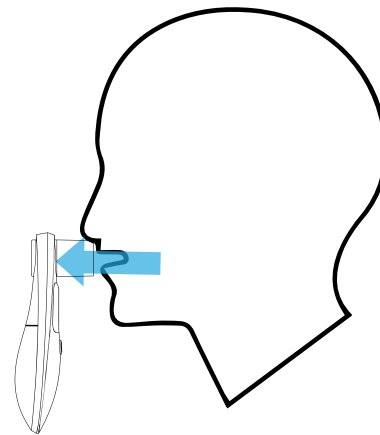

5

Your measurement will be displayed on the Peak Flow Meter screen and the gateway LED should turn green. Press the power button and follow step 4 if you need to take another reading.

